



Set-up guide

hyperoptic

Copyright © 2015 Hyperoptic Limited, Unit C401 Westfield London, Ariel Way, London W12 7FD.



WELCOME TO HYPEROPTIC

Brace yourself

You are only a few minutes away from experiencing the revolutionary speed and stability of Hyperoptic fibre broadband.

You are going to enjoy speeds of up to 1Gb (1000Mb!), depending on the package you have ordered. If you have ordered a slower package and would like to upgrade, please phone us on [0333 332 1120](tel:0333 332 1120).



QUICK SET-UP

Step by step guide

- 1 Plug one end of the black Ethernet cable into the HyperHub's black WAN socket and the other end into Hyperoptic's socket on your wall.
- 2 Plug the power adaptor into your HyperHub and switch on at the mains.
- 3 Press the power button on the back of your HyperHub. The green power light will come on and your HyperHub will connect to Hyperoptic broadband automatically. This may take a few minutes.
- 4 Setup is complete when the green **Power**, **Internet**, **WAN** and **WLAN** light are on. You are ready to connect all devices; laptop, computer, phone, tablet etc.

If the WAN and internet light is not 'on', 20 minutes after installtion process, please call Customer Support.

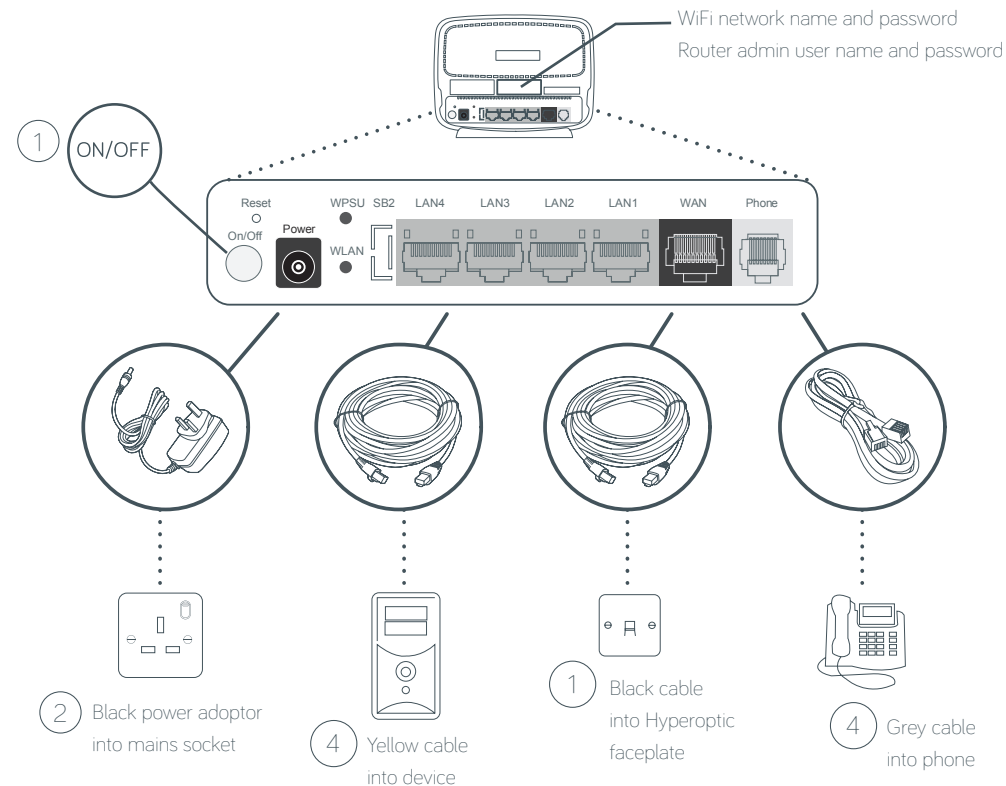



DEVICE CONNECTION

Wired connection

Best for speed. Connect the supplied yellow LAN cable into any of the four yellow LAN ports at the back of your HyperHub and the other end in to your computer's LAN port. Speeds may vary depending on the performance capabilities of your device.

Wifi connection

Best for convenience. Connect your WiFi device to the HyperHub. The WiFi SSID (WiFi network name) and WiFi password are printed on the back of your HyperHub.

Note: WiFi speed is variable. For best speeds and when performing a speed test, use a wired connection.

Phone connection

If you have added 'phone' to your Broadband package you will need to connect it now.

Connect your phone or cordless phone base- station to your HyperHub. Plug the supplied grey coloured cable into your HyperHub's grey phone socket and the other end into your phone.

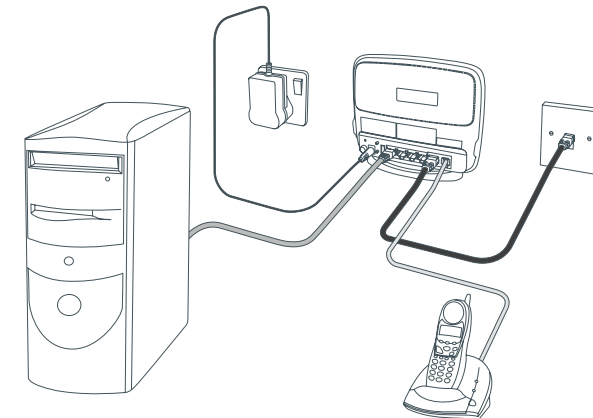



HYPERHUB ADVANCED SETTINGS

Connection and settings

Warning: Changes made to your HyperHub settings may adversely affect your connection if entered incorrectly.

You can access your HyperHub settings from any device connected to your Hyperoptic network. From your web browser type 192.168.11 into the address bar. Your admin username and password can be found on the back of your HyperHub.

For more advanced product features visit hyperoptic.com.

SAFETY INFORMATION

Precautions

When using your HyperHub, and to ensure general safety, you **must** follow these guidelines:

- Treat your HyperHub with care; keep it clean, dust free and well ventilated. Only use a soft, dry cloth to clean your HyperHub.
- Only use the Power Adaptor supplied with your HyperHub.
- Do not open or disassemble any of the parts supplied.
- During an electrical storm remove all connections to device.
- **This is not a toy.** Do not allow children to play with this product.



ANY QUESTIONS

Any questions? Feel free to contact our
hyper-friendly customer support team.

Email: support@hyperoptic.com
Telephone: 0333 332 1120
hyperoptic.com

